

**Foot flanges** serve as supporting element for the combination of an electric motor without foot connected to a bellhousing and hydraulic pump.

### Table of contents

<b>1</b>	<b>Advice</b>	<b>2</b>
1.1	General advice	2
1.2	Safety and advice symbols	2
1.3	General hazard warnings	2
1.4	Intended use	2
<b>2</b>	<b>Storage, transport and packaging</b>	<b>3</b>
2.1	Storage	3
2.2	Transport and packaging	3
<b>3</b>	<b>Assembly</b>	<b>3</b>
3.1	Components of the foot flange	3
3.2	Assembly of bellhousing with foot flange	4
<b>4</b>	<b>Disposal</b>	<b>4</b>
<b>5</b>	<b>Spares inventory, customer service addresses</b>	<b>4</b>



1 Advice

1.1 General advice

Please read through these operating/assembly instructions carefully before you start up the foot flange. Please pay special attention to the safety instructions! The operating/assembly instructions are part of your product. Please store them carefully and close to the foot flange. The copyright for these operating/assembly instructions remains with KTR.

1.2 Safety and advice symbols



Warning of personal injury

This symbol indicates notes which may contribute to preventing bodily injuries or serious bodily injuries that may result in death.



Warning of product damages

This symbol indicates notes which may contribute to preventing material or machine damage.



General advice

This symbol indicates notes which may contribute to preventing adverse results or conditions.

1.3 General hazard warnings



**With assembly and disassembly of the foot flange it has to be made sure that the entire drive train is secured against accidental switch-on. You may be seriously hurt by rotating parts. Please make absolutely sure to read through and observe the following safety indications.**

- All operations on and with the foot flange have to be performed taking into account "safety first".
- Please make sure to switch off the power pack before you perform your work on the foot flange.
- Secure the power pack against accidental switch-on, e. g. by providing warning signs at the place of switch-on or removing the fuse for current supply.
- Do not reach into the operation area of the machine as long as it is in operation.
- Please secure the rotating drive components against accidental contact. Please provide for the necessary protection devices and covers.

1.4 Intended use

You may only assemble and disassemble the foot flange if you

- have carefully read through the operating/assembly instructions and understood them
- had technical training
- are authorized by your company

The foot flange may only be used in accordance with the technical data (see catalogue of hydraulic components). Unauthorized modifications on the foot flange are not admissible. We will not assume liability for any damage that may arise. In the interest of further development we reserve the right for technical modifications.

The **foot flange** described in here corresponds to the technical status at the time of printing of these operating/assembly instructions.

Please observe protection note ISO 16016.	Drawn: 2017-01-02 Sho/Pz	Replacing: KTR-N dated 2015-03-05
	Verified: 2017-01-02 Pz	Replaced by:



**2 Storage, transport and packaging**

**2.1 Storage**

The foot flanges (except for those made of the material aluminium) are supplied in preserved condition and can be stored in a roofed, dry place during 6 - 9 months.



**The storage rooms must not include any ozone-generating devices like e. g. fluorescent light sources, mercury-vapour lamps or electrical high-voltage appliances. Humid storage rooms are not suitable. Please make sure that condensation is not generated. The best relative air humidity is less than 65 %.**

**2.2 Transport and packaging**



**In order to avoid any injuries and any kind of damage please always make use of proper transport and lifting equipment.**

The foot flanges are packed differently each depending on size, quantity and kind of transport. Unless otherwise contractually agreed, packaging will follow the in-house packaging specifications of KTR.

**3 Assembly**

The foot flange is supplied ready for assembly.

**3.1 Components of the foot flange**

Component	Quantity	Description
1	1	Foot flange PTFE or PTFE

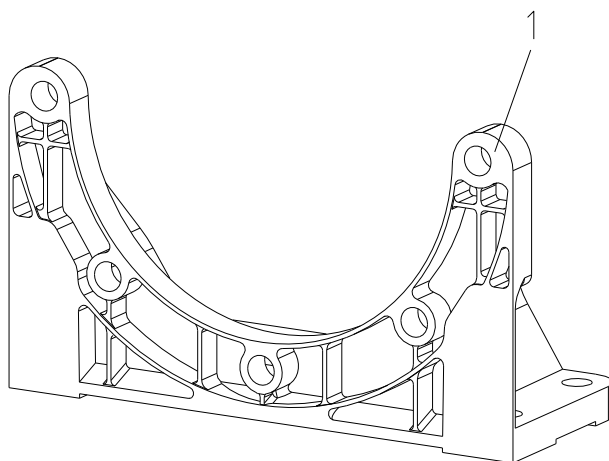

Illustration 1: Foot flange PTFE

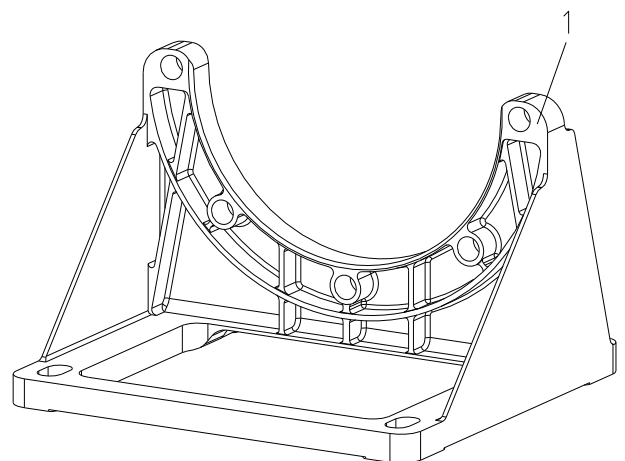

Illustration 2: Foot flange PTFE

**3 Assembly****3.2 Assembly of bellhousing with foot flange**

- The bellhousing is suspended in the foot flange with its external centering ( $\varnothing B3$ ).

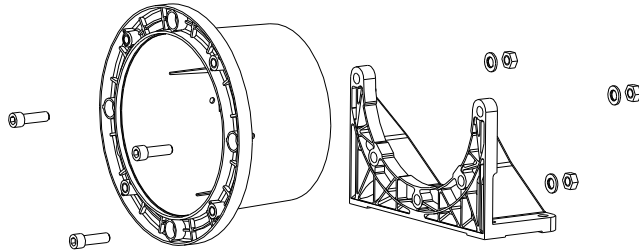

Illustration 3: Combination of bellhousing and foot flange PTFL

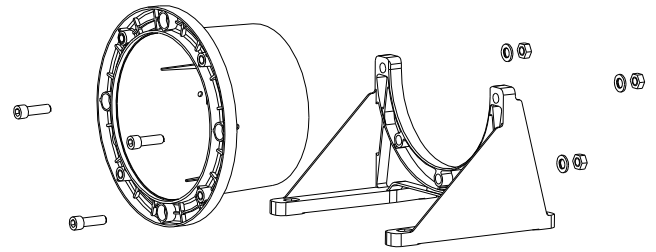

Illustration 4: Combination of bellhousing and foot flange PTFS

- Put the cap screws according to DIN EN ISO 4762 into the through holes of the bellhousing and the foot flange and screw both parts with a nut according to DIN EN ISO 10511 and a disk according to DIN EN ISO 7090 or a similar one. For tightening torques of the screws please refer to table 1.

**Table 1:**

Cap screws DIN EN ISO 4762 <sup>1)</sup>	M8	M10	M12	M16	M20
Tightening torque $T_A$ [Nm] <sup>2)</sup>	23	46	79	195	395

1) min. property class 8.8

2) Tightening torques of property class 8.8; friction coefficient 0.125



**The screws must be generally used with Loctite, Omnifit 230M or similar adhesives for fastening.**



**In order to reach the full loading capacity of foot flanges, all fastening bores have to be screwed to the bellhousing or electric motor and bellhousing.**



**For assembly of the combination of bellhousing and foot flange with the electric motor and pump see KTR-N 41010 „Operating/assembly instructions for bell housings“.**

**4 Disposal**

In respect of environmental protection we would ask you to dispose of the packaging or products on termination of their service life in accordance with the legal regulations and standards that apply, respectively.

All components consist of metal. Any metal components have to be cleaned and disposed of by scrap metal.

**5 Spares inventory, customer service addresses**

A basic requirement to ensure the operational readiness of the foot flange is a stock of the most important spare parts on site.

Contact addresses of the KTR partners for spare parts and orders can be obtained from the KTR homepage at [www.ktr.com](http://www.ktr.com).



**KTR does not assume any liability or warranty for the use of spare parts and accessories which are not provided by KTR and for the damages which may incur as a result.**